

# Upute za montažu Installation instruction

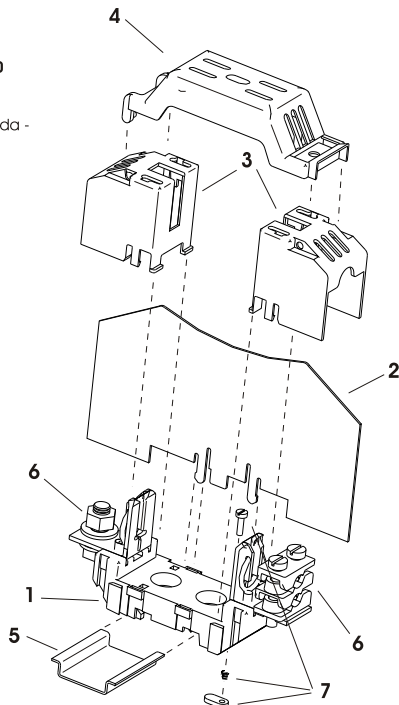

## 1. Podnožje osigurača PLNV-00 i pribor PLNV-00 fuse-base and accessories

1. Podnožje osigurača **PLNV-00**  
Fuse-base **PLNV-00**
2. Međufazna i završna pregrada -  
Phase and end barrier -
3. Zaštitna kapa - **ZP 00**  
Protective cap - **ZP 00**
4. Zaštitni poklopac -  
Protective cover -
5. Profilni nosač 35mm  
Mounting rail 35mm
6. Priključak  
Terminal
7. Montažni pribor **TS**  
Mounting **TS-set**



## 2. Tipovi priključaka / Type of terminals

### a) Vijčani priključak / Screw terminal



Moment pritezanja  
Rated torque

**12 - 15 Nm**

UPOZORENJE!  
PRITEZANJE IZVRŠITI  
SA DVA KLJUČA!



CAUTION!  
SCREW ON WITH  
TWO SCREW - KEYS!

### b) Obuhvatna stezaljka / Clip type terminal

Tip/Type - **OS00**

Moment pritezanja / Rated torque

**4,5 Nm**

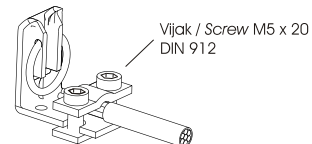

Priključni presjek / Clamping range

**6 - 50mm<sup>2</sup> Cu**

### c) Prizma stezaljka - jednostruka / Prism clamp - single

Tip/Type - **P00**

Moment pritezanja / Rated torque

**4,5 Nm**

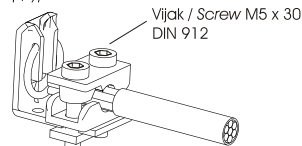

Priključni presjek / Clamping range

**10 - 70mm<sup>2</sup> Al/Cu**

### d) Prizma stezaljka - dvostruka / Prism clamp - double

Tip/Type - **P002**

Moment pritezanja / Rated torque

**4,5 Nm**

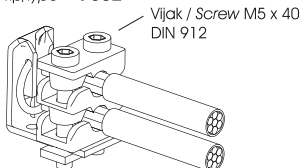

Priključni presjek / Clamping range

**2 x ( 10 - 25mm<sup>2</sup> ) Al/Cu**  
( sa zaštitnom kapom / with protective cap )

**2 x ( 10 - 50mm<sup>2</sup> ) Al/Cu**  
( bez zaštitne kape / without protective cap )

### 3. Pričvršćenje trolpnog podnožja PLNV-00/3 na montažnu ploču

#### Mounting PLNV-00/3 fuse-base on mounting plate

Pričvršćenje trolpnog podnožja PLNV - 00/3 izvesti sa minimalno četiri vijka ( razmak rupa 25 x 68 mm )  
 Fuse - base PLNV - 00/3 fasten with four screws minimally  
 ( distance between holes 25 x 68 mm )

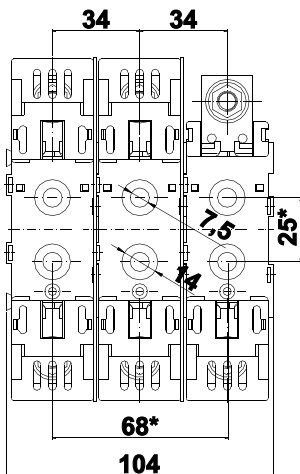

\* Montažne mjere  
 Mounting dimensions

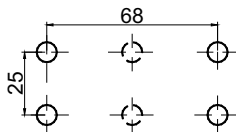

### 4. Pričvršćenje trolpnog podnožja PLNV-00/3 na profilni nosač 35mm

#### Mounting PLNV-00/3 fuse-base on mounting rail 35mm

Pričvršćenje podnožja PLNV-00/3 na profilni nosač 35mm izvesti sa tri montažna pribora TS ( 3 x TS ).  
 Mounting PLNV-00/3 fuse-base on mounting rail 35mm perform with three TS-sets ( 3 x TS ).

### 5. Montaža TS pribora ( vijak, opruga, pločica - matica )

#### TS-set mounting ( screw, spring, plate - nut )

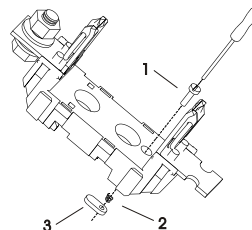

#### TS pribor / TS - set

1. Vijak / Screw M3x10 DIN 84
2. Opruga / Spring
3. Pločica-matica / Plate-nut

#### Mounting instruction of TS-set

-Put the screw (No. 1) in PLNV-00 fuse-base  
 -Put the spring (No.2) on the screw  
 -Put the plate-nut (No.3) on the screw and then screw on with a screw-driver until the end of the screw trough all the plate-nut pass. Final position of the plate-nut, also the starting position for mounting PLNV-00 fuse-base on mounting rail 35mm, correspond to position in the picture below.

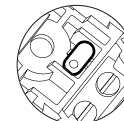

#### Postupak montaže TS pribora

- Umetnuti vijak (br. 1) u podnožje PLNV-00  
 - Staviti oprugu (br. 2) na vijak  
 - Staviti pločicu-maticu (br. 3) na vijak i vijak uvrćavati tako dugo dok kraj vijka prođe kroz cijelu pločicu-maticu. Krajnji položaj pločice-matrice mora odgovarati položaju na slici desno. To je ujedno i početni položaj za montažu PLNV-00 podnožja na profilni nosač 35mm.

### 6. Pričvršćenje podnožja PLNV-00 na profilni nosač 35mm

#### Mounting the PLNV-00 fuse-base on mounting rail 35mm

#### Postupak montaže podnožja PLNV-00 na profilni nosač 35mm

- Zakvačiti podnožje na profilni nosač  
 - Spustiti donji dio podnožja na nosač i odvijačem "X" pritegnuti vijak ( slika desno )

**Objašnjenje:** Prilikom pritezanja vijka pločica-matica se automatski zakreće za 90° i priteže podnožje na profilni nosač ( slika desno dolje ).

#### Mounting instruction for the fuse-base PLNV-00 on mounting rail 35mm

- Hang up fuse-base PLNV-00 on mounting rail 35mm  
 - Lean to lower part of the fuse-base on the mounting rail and screw on with a screw-driver "X" ( right picture-above )

**Explanation:** By tightening the plate-nut is turning on automatically by 90° and tight the fuse-base on the mounting rail ( right picture ).

